

SD38

SD56

SD73

SD110



BID SPECIFICATIONS

STANDARD

- * SELF-CONTAINED, AIR-COOLED CONDENSING UNIT
- * TEMPERED GLASS FRONT AND SIDES
- * DIGITAL DIAGNOSTIC CONTROL SYSTEM
- * HYDRAULIC LIFT UP FRONT GLASS
- * STAINLESS STEEL INTERIOR AND EXTERIOR BACK
- * REFRIGERATED DECK, NON-REFRIGERATED SHELVES
- * REAR PLEXIGLAS DOORS
- * STAINLESS STEEL WORK SURFACE
- * DISPLAY CASE(S) TO BE SHIPPED FULLY ASSEMBLED
- * THE STANDARD LIMITED WARRANTY INCLUDES:
5 YEAR COMPRESSOR; 1 YEAR PARTS; 90 DAYS LABOR
- * DISPLAY CASE(S) TO BE LABORATORY CERTIFIED AS DESCRIBED

OPTIONAL

- * CASTERS
 - * GRANITE WORK SURFACE (OPERATOR SIDE)
 - * REMOTE CONDENSING UNIT
 - * REAR AIR INTAKE AND DISCHARGE
 - * DECORATIVE SIDE PANELS
- * SIDE & FRONT PANELS PAINTED IN A GLOSSY FINISH (CASE SHIP IN BUFF WHITE PRIMER)

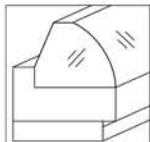

STANDARD END PANEL



DECORATIVE END PANEL

Sacher Deli Refrigerated Case Technical Specifications

Same as Pastry Cases, no drawer

Updated Model no.	Old Model No.	Factory Code	Case Height	*Case Length	Case Depth	Crated Weight (lb)	Line Voltage	Breaker Size	Amp Draw	Working Temp F	Comp. HP
SD38	C83S-3SC	RVS 2M	55.50"	37.16"	41.61"	840	115/1/60	20amps	10	41	1/3 HP
SD56	C83S-5SC	RVS 3M	55.50"	55.43"	41.61"	1245	115/1/60	20amps	11	41	1/2 HP
SD73	C83S-7SC	RVS 4M	55.50"	73.34"	41.61"	1566	115/1/60	20amps	11	41	1/2 HP
SD110	C83S-9SC	RVS 6M	55.50"	109.95"	41.61"	2127	115/1/60	20amps	12	41	3/4 HP

*Case lengths are specified with standard end panels

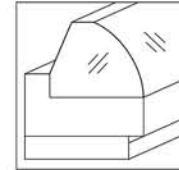

STANDARD END PANEL



DECORATIVE END PANEL

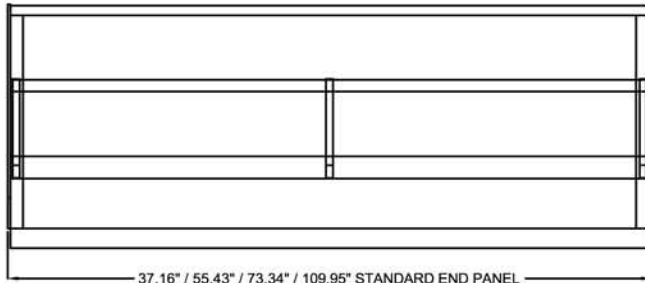

37.16" / 55.43" / 73.34" / 109.95" STANDARD END PANEL

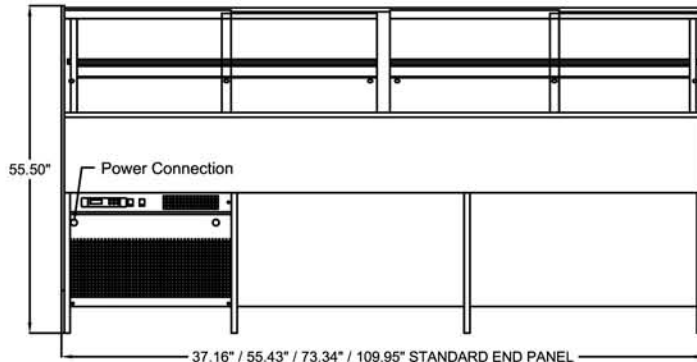

37.16" / 55.43" / 73.34" / 109.95" STANDARD END PANEL

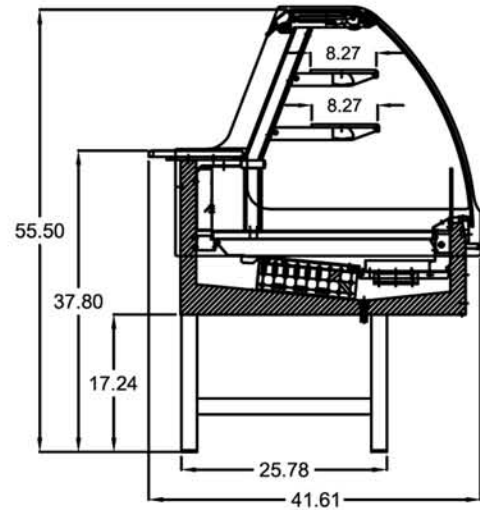

SIDE VIEW

PLAN & REAR VIEW

LISTINGS:



ELECTRICAL CONNECTION:

Display cases are shipped with applicable junction box for hardwired installation
Options exist for several NEMA configurations
Plug and/or receptacle configurations are at the discretion of the electrical installer

NOTE:

Required ambient conditions: 75°F; 55% RH
Drawing and Specifications are subject to change without notice

CLABO North America, LLC
33300 Central Avenue
Union City, CA 94587 USA
PH 800.672.2784
FAX 510.441.0401
<http://www.otl-usa.com>